

# Conference Venue - Stockholm University

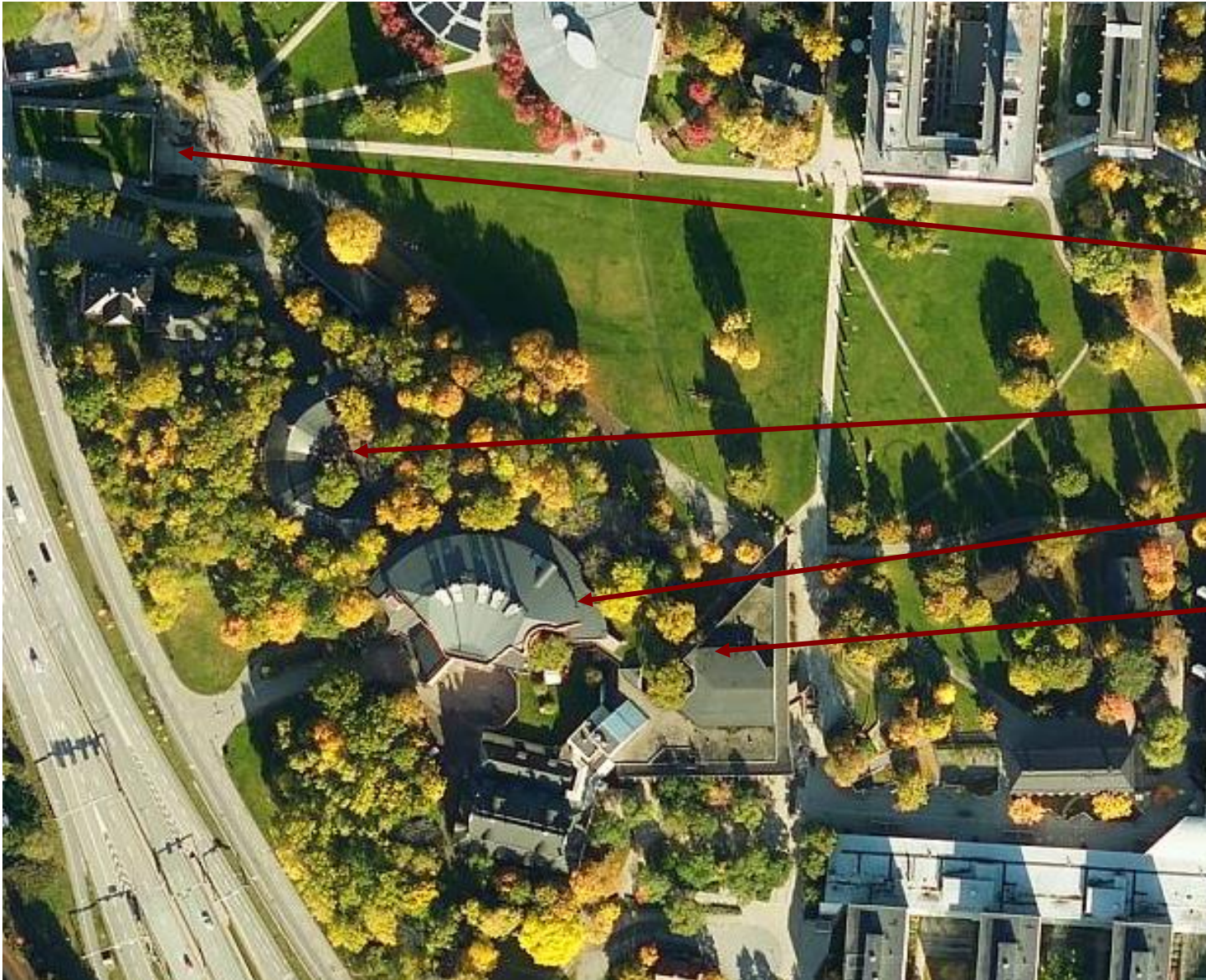

Exit from the subway (T-bana) Station: Universitetet (red line)

Juridicum

Aula Magna

Rotundan

# Conference Venue - Stockholm University

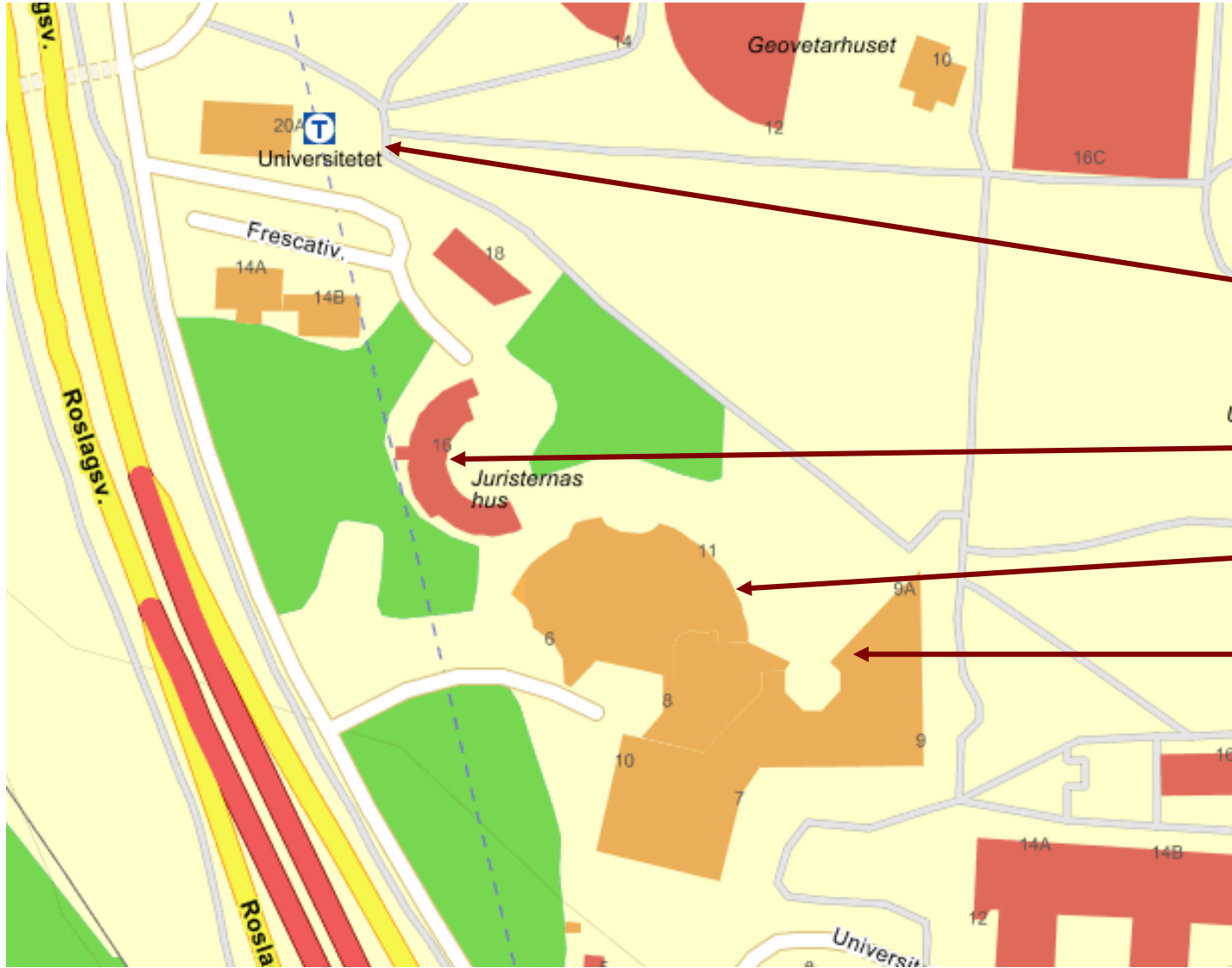

Exit from the subway (T-bana) Station: Universitetet (red line)

Juridicum

Aula Magna

Rotundan



# Aula Magna – level 4 (entrance level)

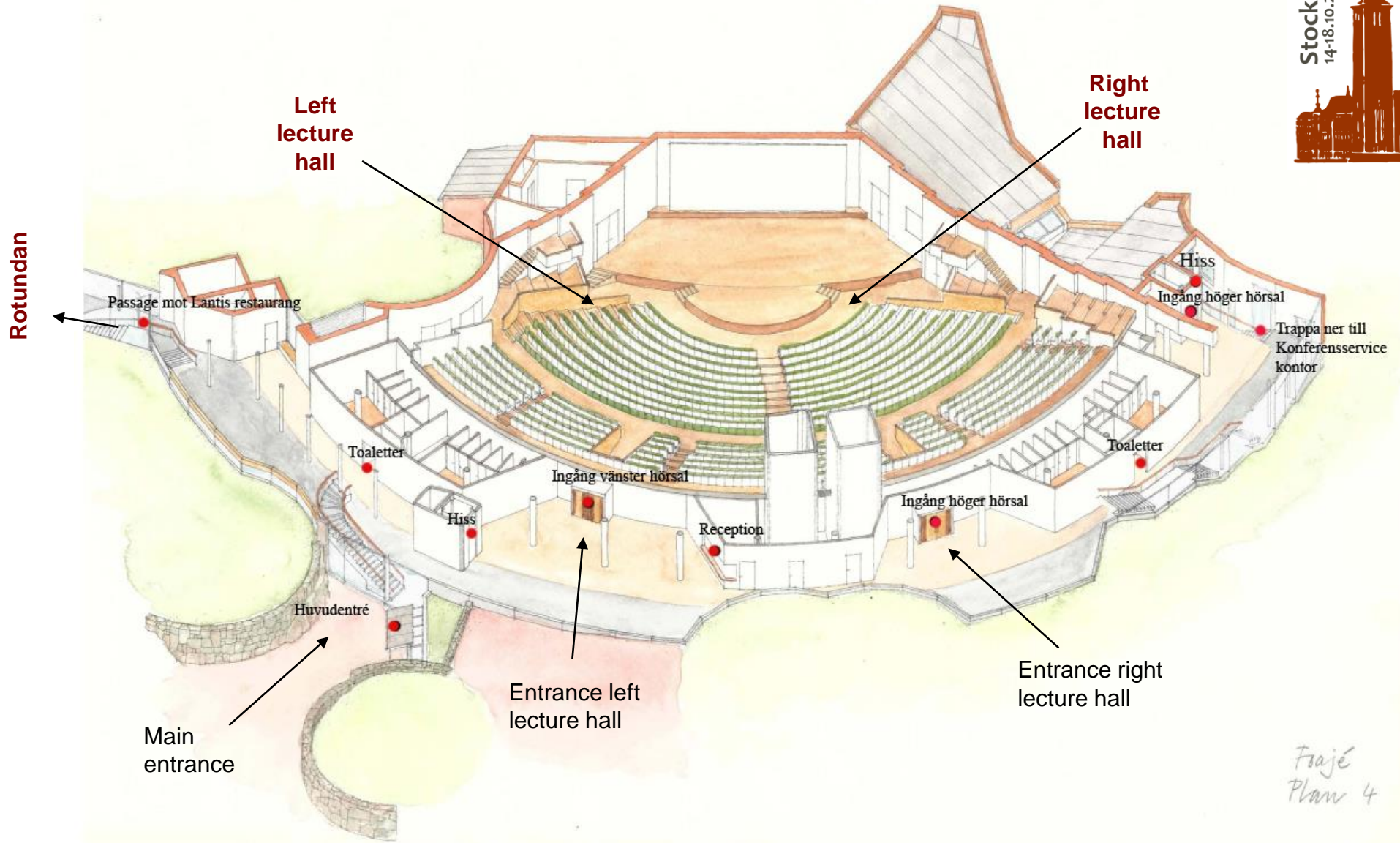

Foajé  
Plan 4

### Some useful Swedish words:

hiss = lift, trappor = stairs, ingång = entrance, utgång = exit, höger = right, vänster = left, hörsal = lecture hall, plan = level, ner = down, upp = up

# Aula Magna – level 5

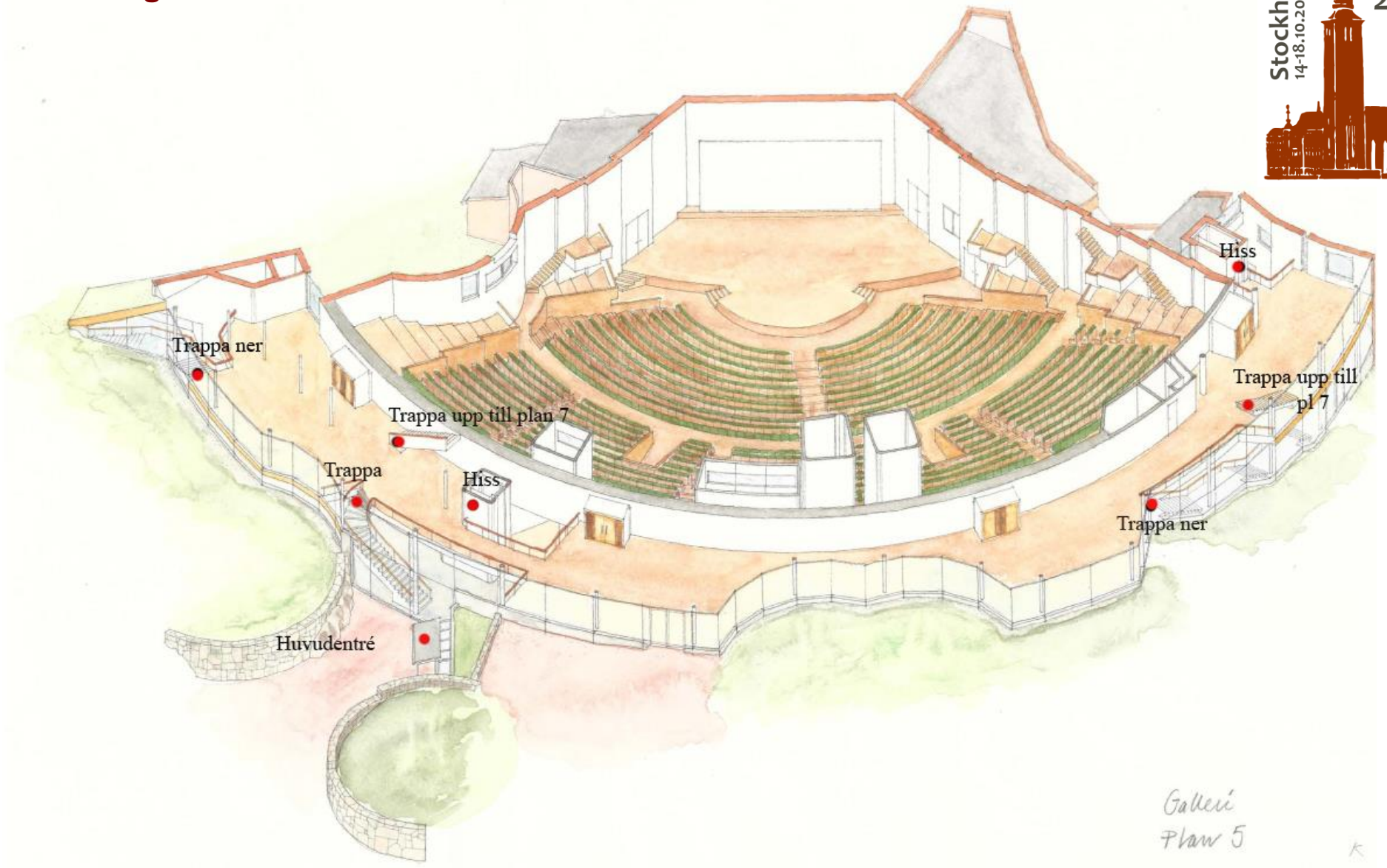

Galleri  
Plan 5

## Some useful Swedish words:

hiss = lift, trappor = stairs, ingång = entrance, utgång = exit, höger = right, vänster = left, hörsal = lecture hall, plan = level, ner = down, upp = up



# Aula Magna – level 7 (top level)

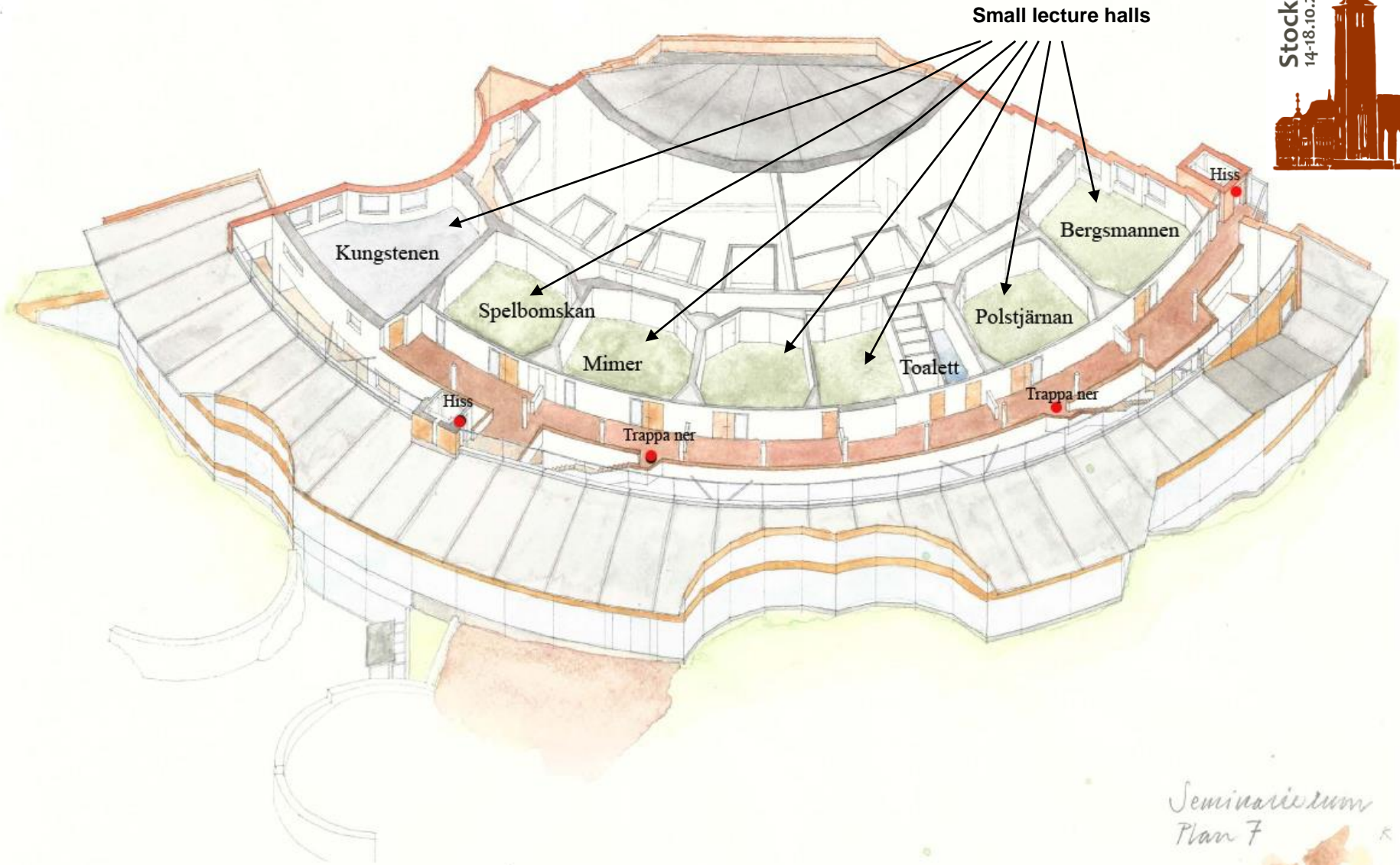

*Seminarium  
Plan 7*

## Some useful Swedish words:

hiss = lift, trappor = stairs, ingång = entrance, utgång = exit, höger = right, vänster = left, hörsal = lecture hall, plan = level, ner = down, upp = up